

# KOMODA 100

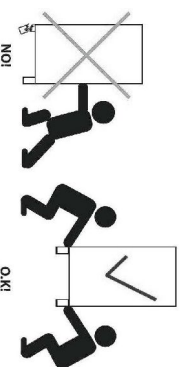

6.6.2017

- D** Montageanleitung
- FR** Notice de montage
- NL** Handleiding voor de montage
- CZ** Montážní návod
- HU** Szerelési útmutató
- TR** Montaj talimatı
- GB** Assembly Instructions
- IT** Istruzioni di montaggio
- PL** Instrukcja montażu
- SK** Návod na montáž
- RO** Instrucțiuni de montaj
- RU** Инструкции по монтажу

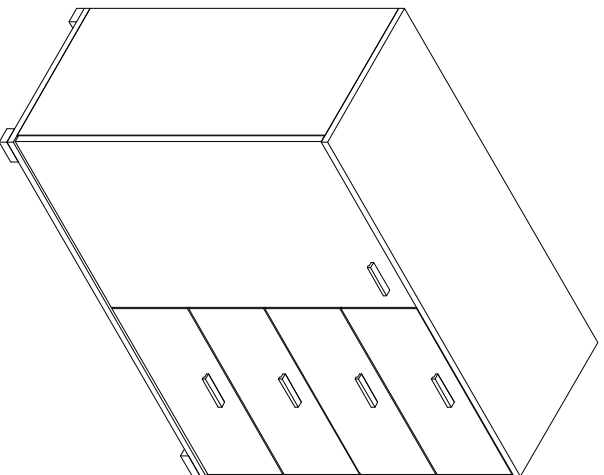
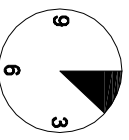
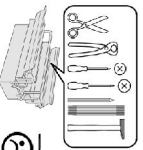

20 min.

1

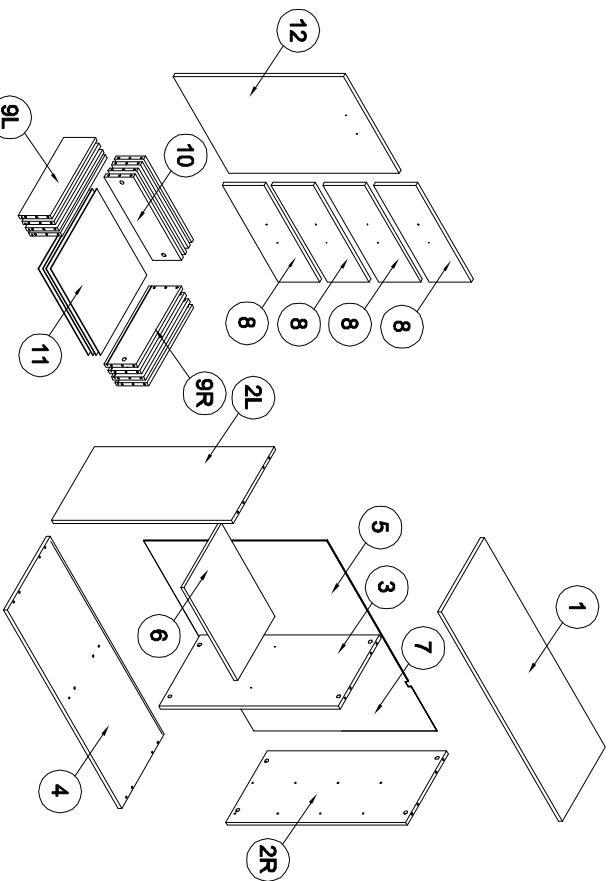

|    |     |   |             |     |    |    |      |    |    |    |     |   |     |   |     |
|----|-----|---|-------------|-----|----|----|------|----|----|----|-----|---|-----|---|-----|
| ZC | X5  | Y | X5          | W   | X5 | YA | 4x27 | TB | X1 | TA | X1  | C | X28 | Z | X28 |
| B  | X28 | A | 6x32<br>X44 | RPS | X4 | RC | X10  | PC | X2 | NA | X5  | N | X24 | X | X4  |
| H  | X4  | H | 6,5x13      | X4  |    | RC | X2   | PC | X2 | NB | X24 | N | X21 | X | X8  |
|    |     |   |             |     |    |    |      |    |    |    |     |   |     |   |     |
|    |     |   |             |     |    |    |      |    |    |    |     |   |     |   |     |
|    |     |   |             |     |    |    |      |    |    |    |     |   |     |   |     |
|    |     |   |             |     |    |    |      |    |    |    |     |   |     |   |     |
|    |     |   |             |     |    |    |      |    |    |    |     |   |     |   |     |
|    |     |   |             |     |    |    |      |    |    |    |     |   |     |   |     |
|    |     |   |             |     |    |    |      |    |    |    |     |   |     |   |     |

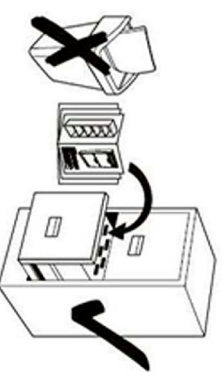
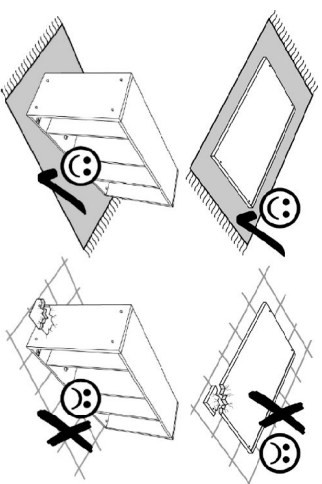

2

3

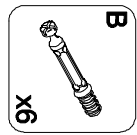
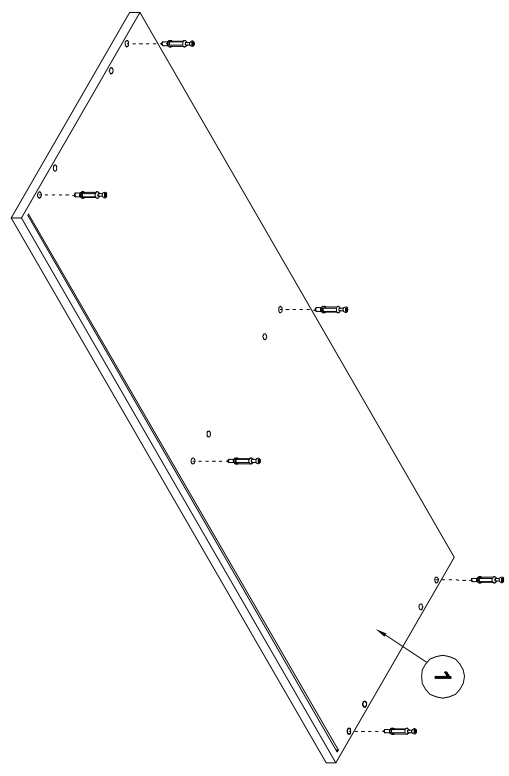
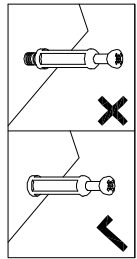

4

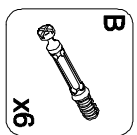
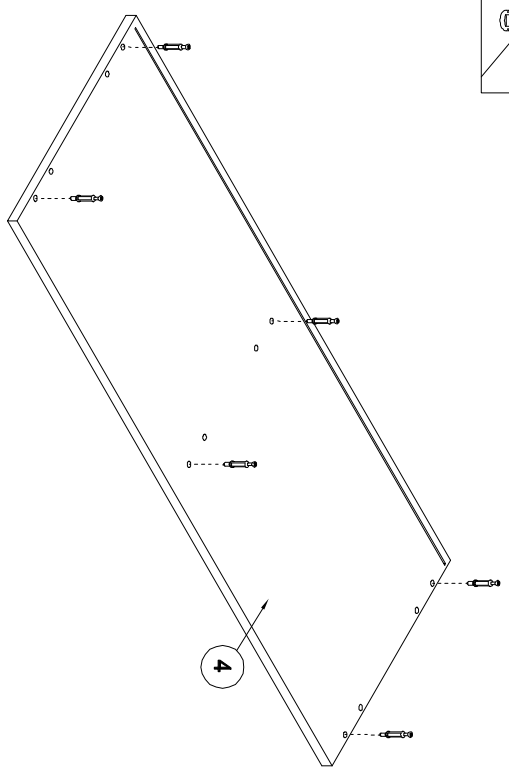
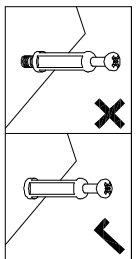

5

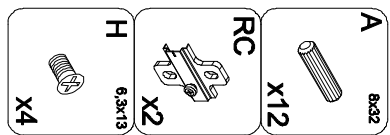
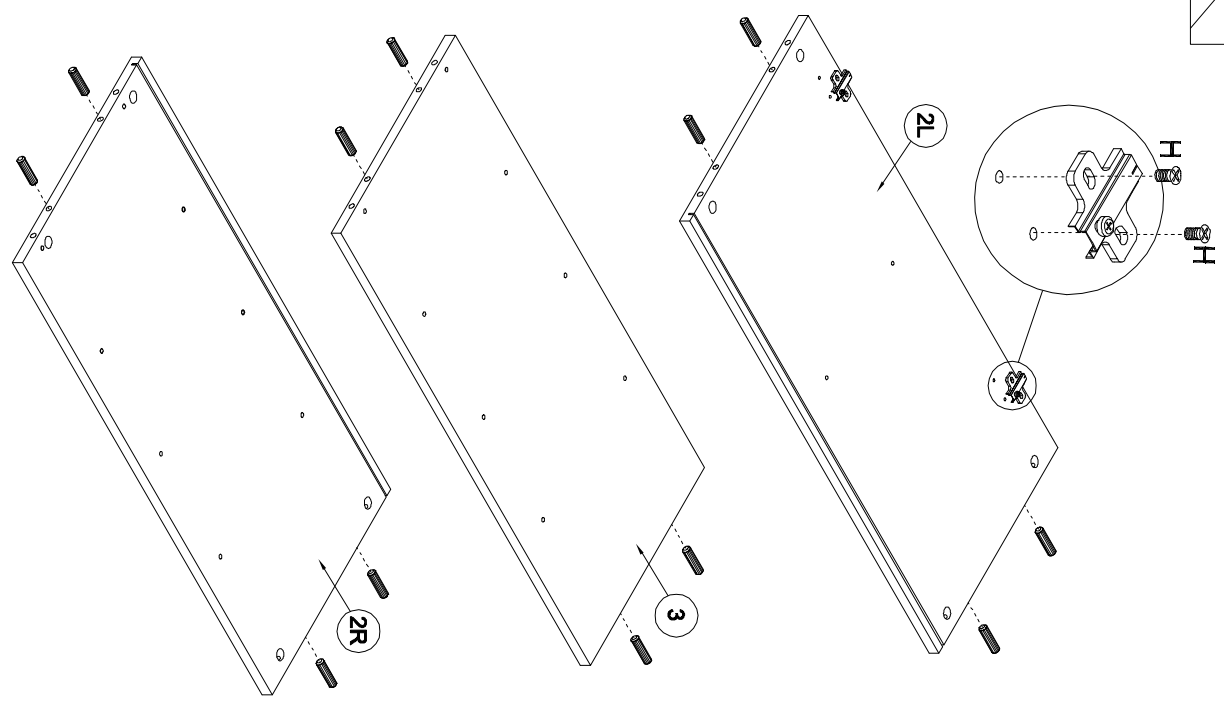
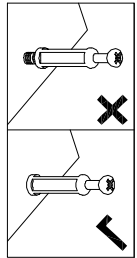

6

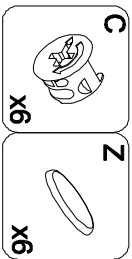
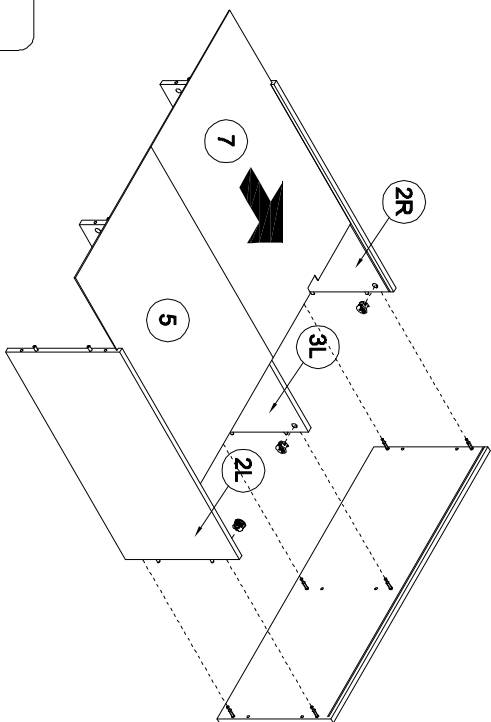
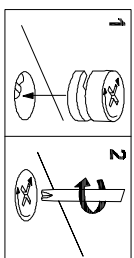

8

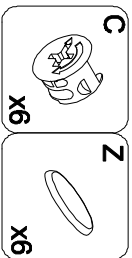
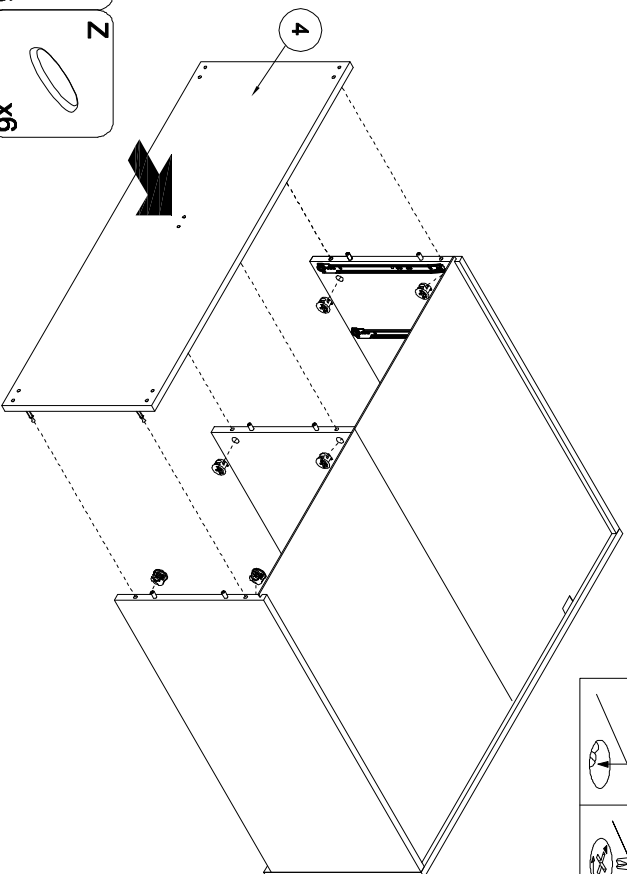
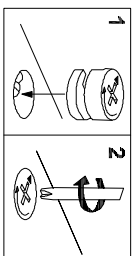

1

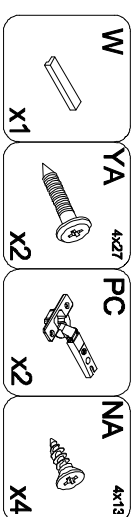
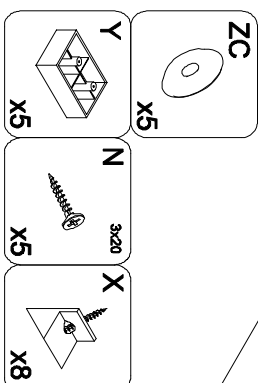
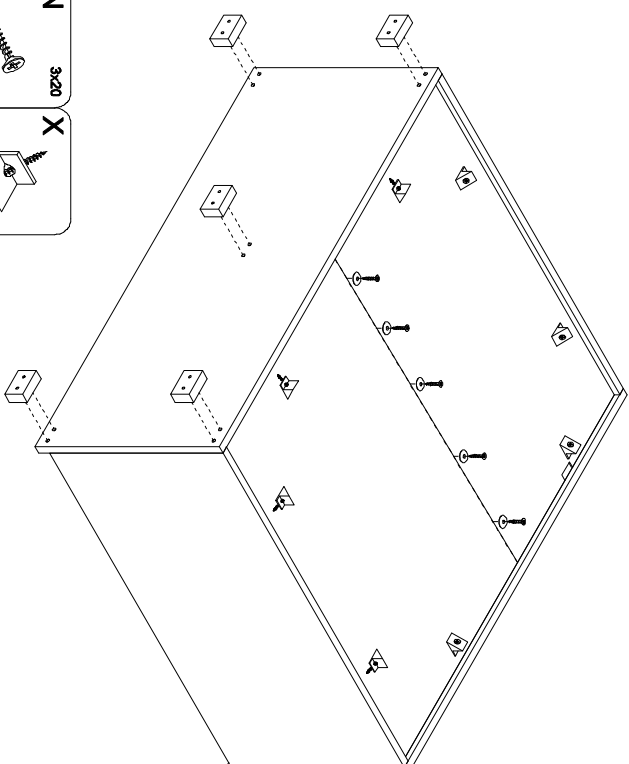

9

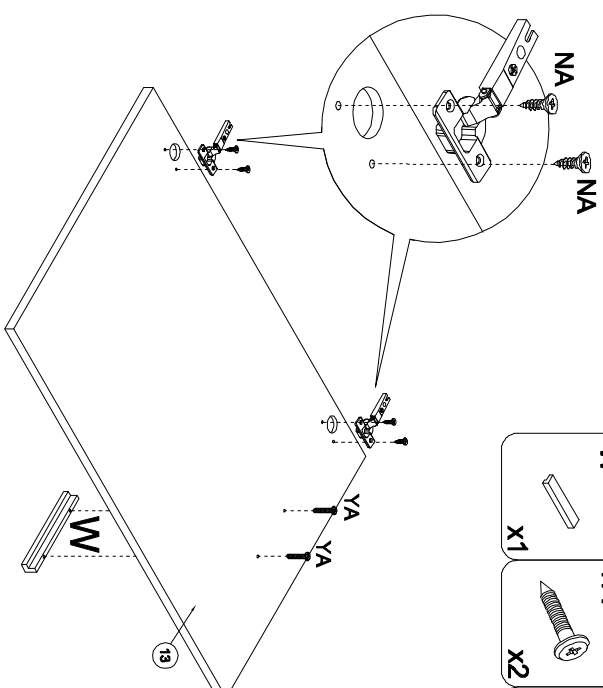

10

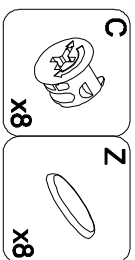
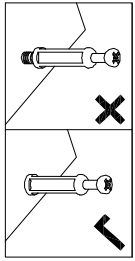
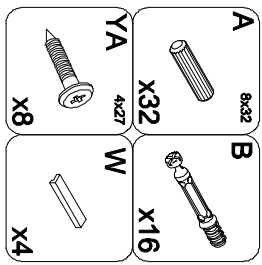
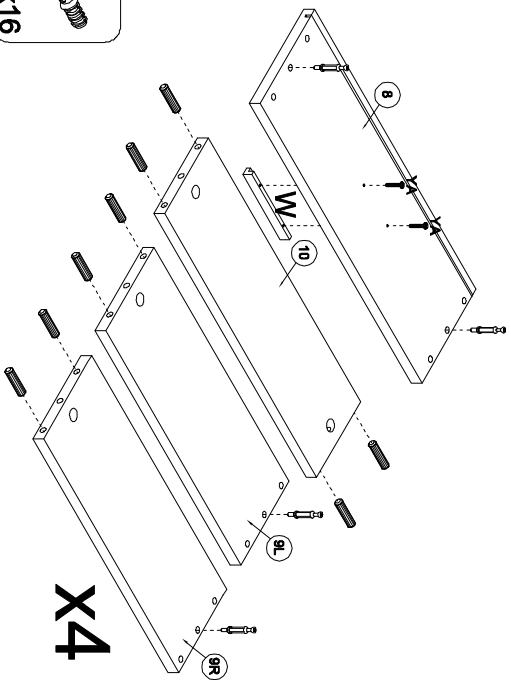

11

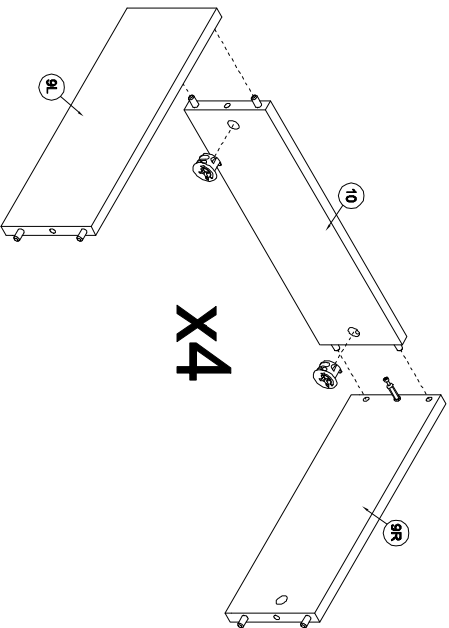

12

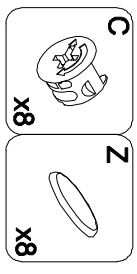
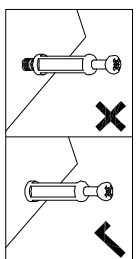
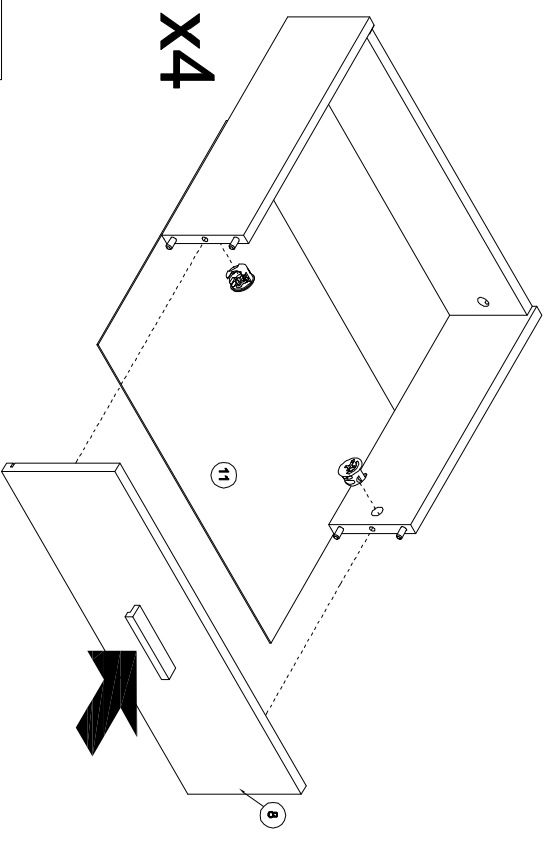

13

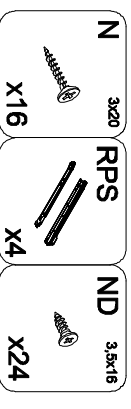
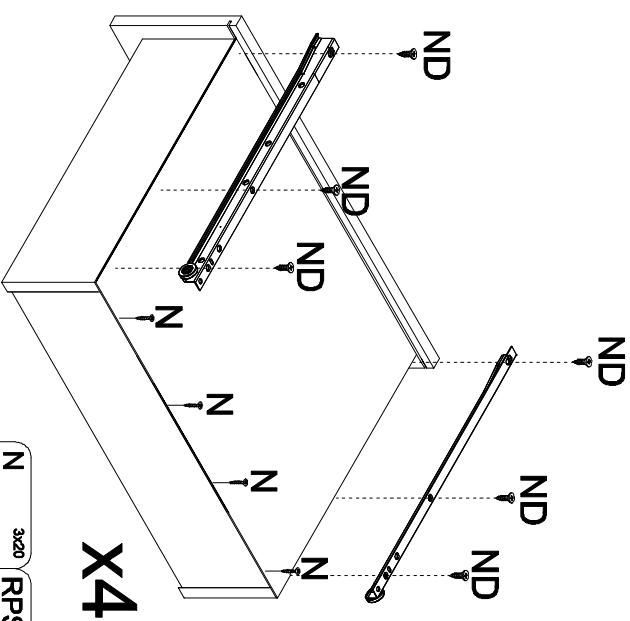

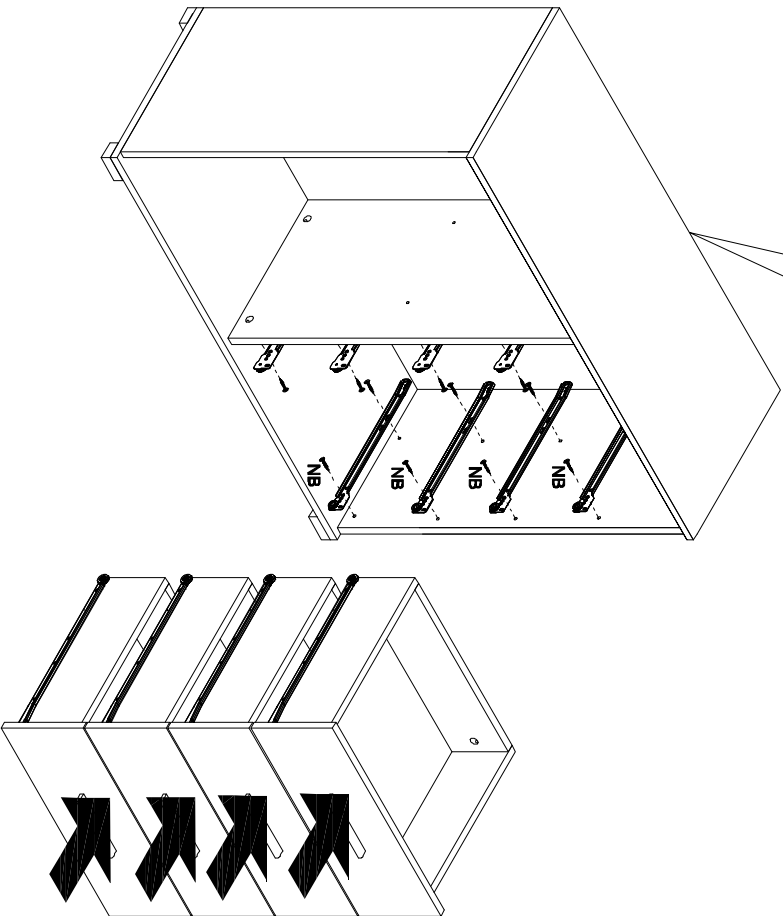
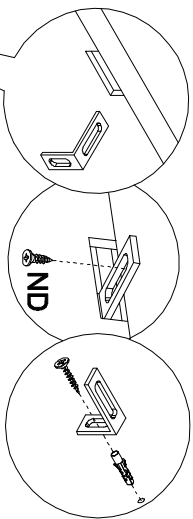

- NB 3.6x13 x24
- RPS x4
- TB x1
- TA x1
- NA 4x13 x1

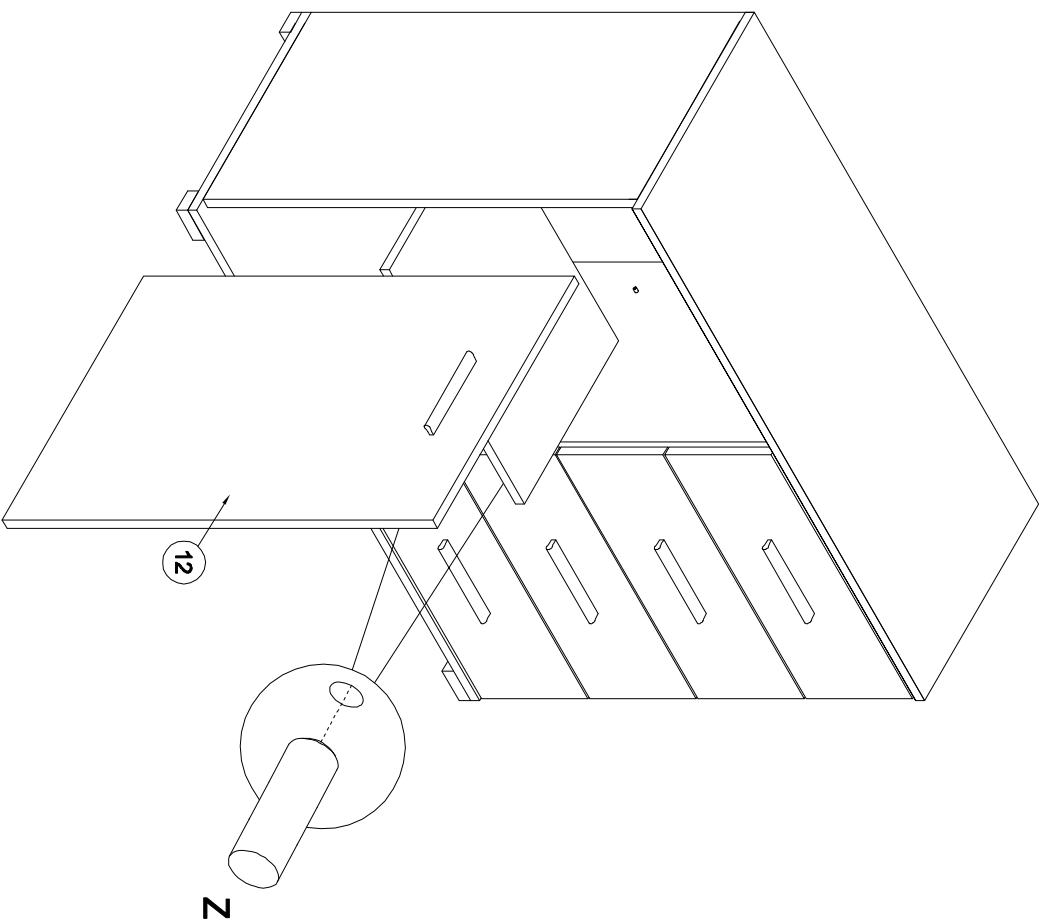
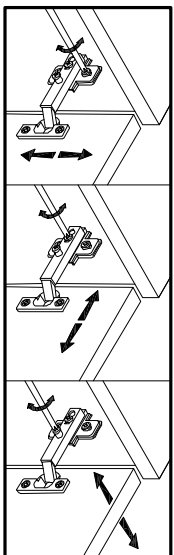

- Z x4